

**Overview of Testing Results for Lead in Drinking Water
and Corrective Actions for
Joint Expeditionary Base Little Creek-Fort Story YC (Building 457)**

The Navy is committed to maintaining safe drinking water on its installations. City water supplied to the Navy and the Navy's water distribution system is regularly tested and in compliance with the Safe Drinking Water Act. Because lead exposure is a particular concern for children, and lead may be added to drinking water through the pipes, fittings, solder, and fixtures inside a building, the Environmental Protection Agency (EPA) recommends, but does not mandate, that we test the lead content of drinking water in priority areas such as youth centers (YCs), child development group homes (CDGHs), and child development centers (CDCs). The Navy has adopted the recommendation as policy.

Navy environmental personnel conducted lead testing at the Fort Story YC in accordance with Navy and EPA guidelines. Samples from various locations in the YC were sent to a state-certified laboratory for analysis.

At the Fort Story YC, outlets used for drinking, cooking, and washing were tested. Out of 9 samples collected, no water outlets tested above the EPA-recommended screening level for lead in drinking water in schools and childcare centers of 20 parts per billion (ppb).

A copy of all test results is enclosed for your information. The test results are presented in two tables:

- Table 1 **Summary of Results** summarizes the data by category of use (e.g., drinking, cooking, washing).
- Table 2 **Summary Statistics** summarizes all the data.

A floor plan of the Fort Story YC has also been included to show the locations of the fixtures that were sampled.

Table 1 provides a description of each sampling location using three columns; *Category*, *Sampling ID*, and *Outlet Description*. The *Category* column gives information about whether the outlet is used for drinking water (water fountain), cooking (food preparation), or washing (primarily hand-washing or brushing teeth). The *Sample ID* column is the identification used to label each sample bottle. The *Outlet Description* column contains additional information to describe the outlet sampled under each category.

The next set of columns in **Table 1** provide *Initial Sampling Results*, and for those locations that exceeded the recommended screening level of 20 ppb the *Re-sampling Results*.

EPA sampling protocol requires water to not be used for between 8 and 18 hours prior to first draw sampling. Therefore, *Initial Sampling Results* were from first draw samples collected early in the morning before the YC opened and before any water was used. The *Initial Sampling Results* also indicate whether resampling is required and the date that fixtures greater than 20 ppb were secured.

The *Re-sampling Results*, *Corrective Actions*, and *Post Remediation Sampling Results* columns are annotated N/A (not applicable) since all the samples at the Fort Story YC were within EPA recommended levels.

To learn more about lead in drinking water in schools and day care centers visit the following EPA website: <https://www.epa.gov/dwreginfo/lead-drinking-water-schools-and-child-care-facilities>.

To learn more about your home's public water supplier, see their annual water quality report: https://www.cnic.navy.mil/regions/cnrma/om/environmental_support/water_quality_information.html

To answer any questions you may have on the sampling program contact the JEB Little Creek-Fort Story Public Affairs Officer at 757-462-8425. If you have any health questions or concerns, you are encouraged to contact your health care provider or, if you are a TRICARE beneficiary, use the Mid-Atlantic Appointment Center to schedule an appointment with your primary care provider at 1-866-645-4584.

Enclosures:

1. Complete Test Results
2. Floor Plan of the Fort Story YC

Sample Summary Results Table
 Priority Areas Lead Testing and Corrective Actions (October 2017)
 Fort Story Youth Center, Building 457

Table 1. Summary of Results

SAMPLING LOCATION DESCRIPTION					INITIAL SAMPLING RESULTS			RE-SAMPLING RESULTS			CORRECTIVE ACTIONS	POST REMEDIATION SAMPLING	
CATEGORY	SAMPLE ID NO.	SAMPLE ID	Outlet Description	Comments	First Draw (ppb)	Retest required?	Date Fixture Secured?	Lead Screening Level of 20 ppb				Description	Recommended Level = 20 ppb
								Water Fountain 15 min. Follow up Flush Sample - Collected day before First Draw Sampling (ppb)	First Draw (ppb)	Follow up Flush - Collected 30 seconds after First Draw Sampling (ppb)	First Draw (ppb)		Follow up Flush - Collected 30 seconds after First Draw Sampling (ppb)
SAMPLING DATE					10/13/2017			N/A	N/A	N/A		N/A	
RESULTS DATE					10/23/2017			N/A	N/A	N/A		N/A	
DRINKING	2	FS-457-HALL-WFCA-FD	Water fountain cooler (low) in Hallway		non-detect	No	N/A	N/A	N/A	N/A	N/A	N/A	N/A
DRINKING	3	FS-457-HALL-WFCB-FD	Water fountain cooler (high) in Hallway		non-detect	No	N/A	N/A	N/A	N/A	N/A	N/A	N/A
COOKING	10	FS-457-K-K-FD	Kitchen sink used for food preparation and dishwashing in the kitchen	Used for filling water jugs	non-detect	No	N/A	N/A	N/A	N/A	N/A	N/A	N/A
WASHING	4	FS-457-BATHA-HHWA-FD	High handwashing faucet in Women's Restroom (Restroom A)		non-detect	No	N/A	N/A	N/A	N/A	N/A	N/A	N/A
WASHING	5	FS-457-BATHA-LHW-FD	Low handwashing faucet in Women's Restroom (Restroom A)		non-detect	No	N/A	N/A	N/A	N/A	N/A	N/A	N/A
WASHING	6	FS-457-BATHA-HHWB-FD	High handwashing faucet in Women's Restroom (Restroom A)		non-detect	No	N/A	N/A	N/A	N/A	N/A	N/A	N/A
WASHING	7	FS-457-BATHB-HHWA-FD	High handwashing faucet in Men's Restroom (Restroom B)		non-detect	No	N/A	N/A	N/A	N/A	N/A	N/A	N/A
WASHING	8	FS-457-BATHB-LHW-FD	Low handwashing faucet in Men's Restroom (Restroom B)		1	No	N/A	N/A	N/A	N/A	N/A	N/A	N/A
WASHING	9	FS-457-BATHB-HHWB-FD	High handwashing faucet in Men's Restroom (Restroom B)		1	No	N/A	N/A	N/A	N/A	N/A	N/A	N/A

Sample Summary Results Table
 Priority Areas Lead Testing and Corrective Actions (October 2017)
 Fort Story Youth Center, Building 457

Table 2. Summary Statistics

CATEGORY	INITIAL SAMPLING RESULTS		RE-SAMPLING RESULTS			POST
	Lead Screening Level of 20 ppb					
	First Draw (ppb)		Water Fountain Follow up Flush Sample - Collected day before First Draw Sampling (ppb)	First Draw (ppb)	Follow up Flush - Collected 30 seconds after First Draw Sampling (ppb)	First Draw (ppb)
Total Drinking	2		N/A	N/A	N/A	N/A
Total Drinking > 20 ppb	0		N/A	N/A	N/A	N/A
Total Cooking	1		N/A	N/A	N/A	N/A
Total Cooking > 20 ppb	0		N/A	N/A	N/A	N/A
Total Washing	6		N/A	N/A	N/A	N/A
Total Washing > 20 ppb	0		N/A	N/A	N/A	N/A
Total Samples	9		N/A	N/A	N/A	N/A
Total Samples > 20 ppb	0		N/A	N/A	N/A	N/A

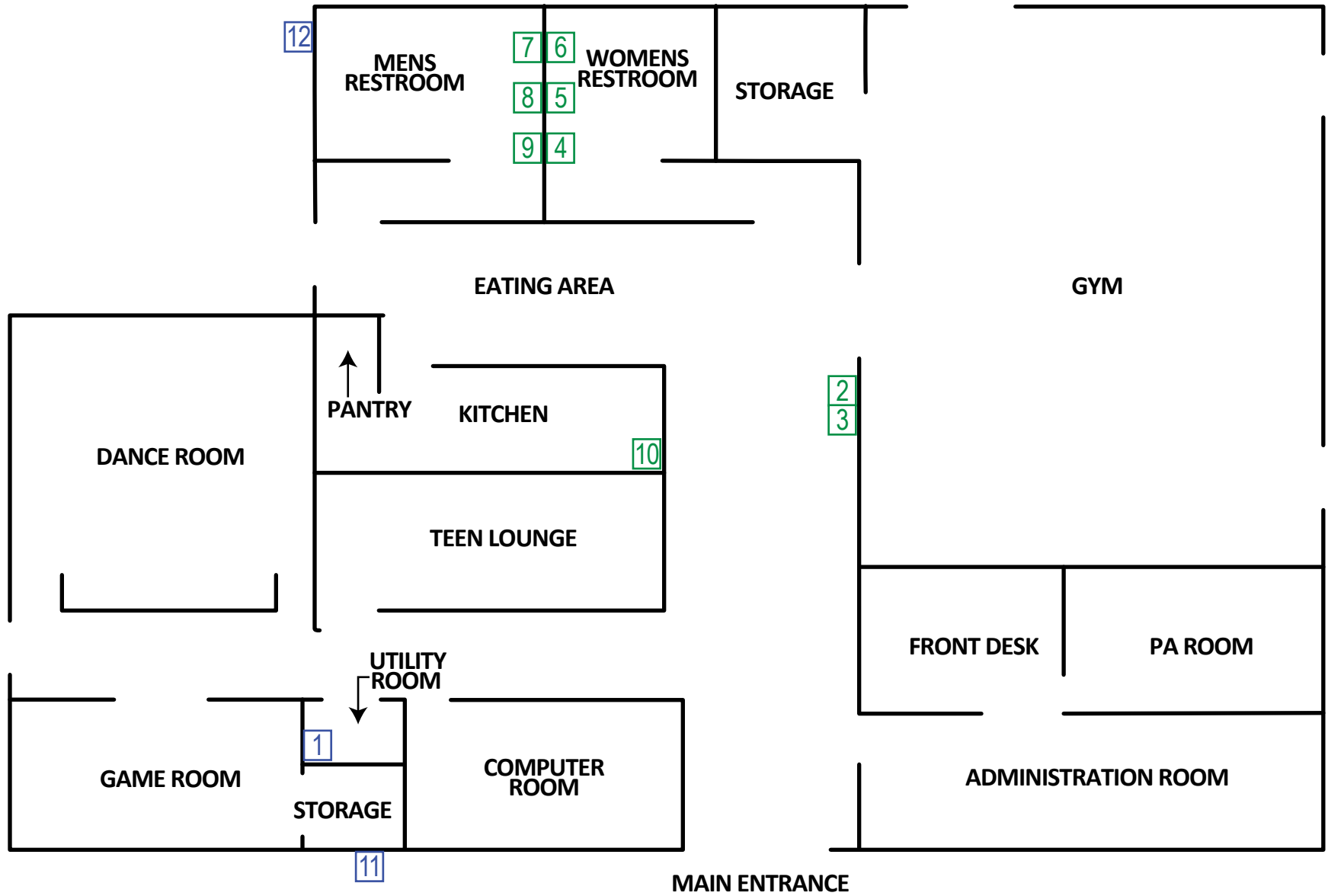

1 BUILDING 457 - FLOOR PLAN

NOT TO SCALE



Outlet numbers pertaining to the floor plan.
 Red = Above 20 ppb
 Green = Below 20 ppb
 Blue = Not Sampled

No.	Type of Fixture	Location Description	Exceeded?
1	Utility sink	Utility Room	Not sampled
2	Water fountain cooler (low)	Hallway	No
3	Water fountain cooler (high)	Hallway	No
4	High handwashing faucet	Women's Restroom (Restroom A)	No
5	Low handwashing faucet	Women's Restroom (Restroom A)	No
6	High handwashing faucet	Women's Restroom (Restroom A)	No
7	High handwashing faucet	Men's Restroom (Restroom B)	No
8	Low handwashing faucet	Men's Restroom (Restroom B)	No
9	High handwashing faucet	Men's Restroom (Restroom B)	No
10	Kitchen sink used for food preparation and dishwashing	Kitchen	No
11	Hose outlet	Outside on the southwest side of Building 457	Not sampled
12	Hose outlet	Outside on the northwest side of Building 457	Not sampled

Outlet numbers pertaining to the floor plan.
 Red = Above 20 ppb
 Green = Below 20 ppb
 Blue = Not Sampled